

**ECoS 2 (50200) (2-Leiter Gleis): Externe Stop/Go-Taster anschließen (Wechselspannungsversorgung)**  
**ECoS 2 (50200) (2-rail conductor): Connecting external Stop/Go push-buttons (AC voltage supply)**

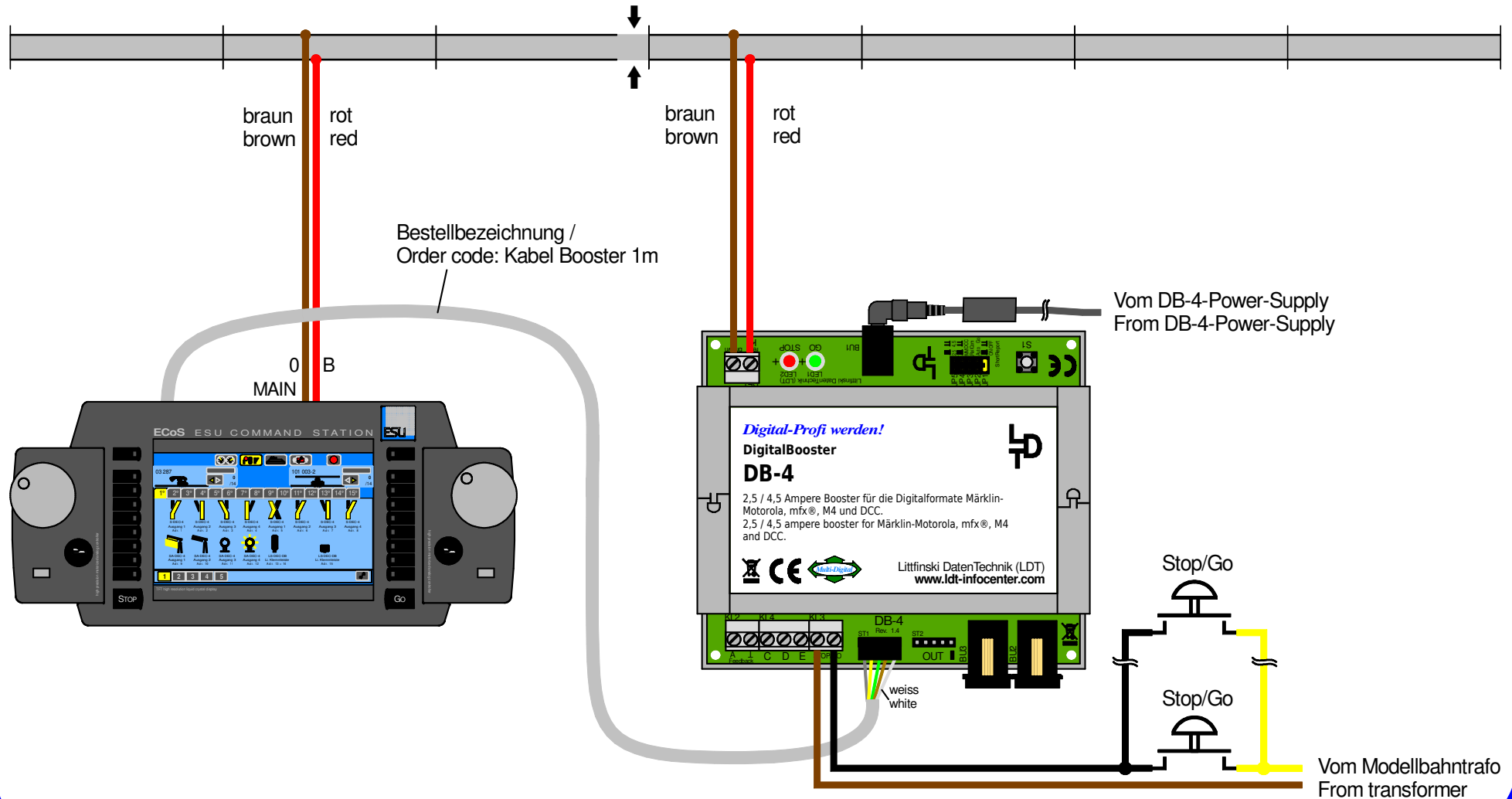

Technische Änderungen und Irrtum vorbehalten.  
 Subject to technical changes and errors.  
 © 09/2020 by LDT

