

TWIN-CENTER (2-Leiter Gleis): DigitalBooster DB-4 über 5-poligen Boosterbus anschließen
TWIN-CENTER (2-rail conductor): Connecting the DigitalBooster DB-4 via 5-poles booster bus

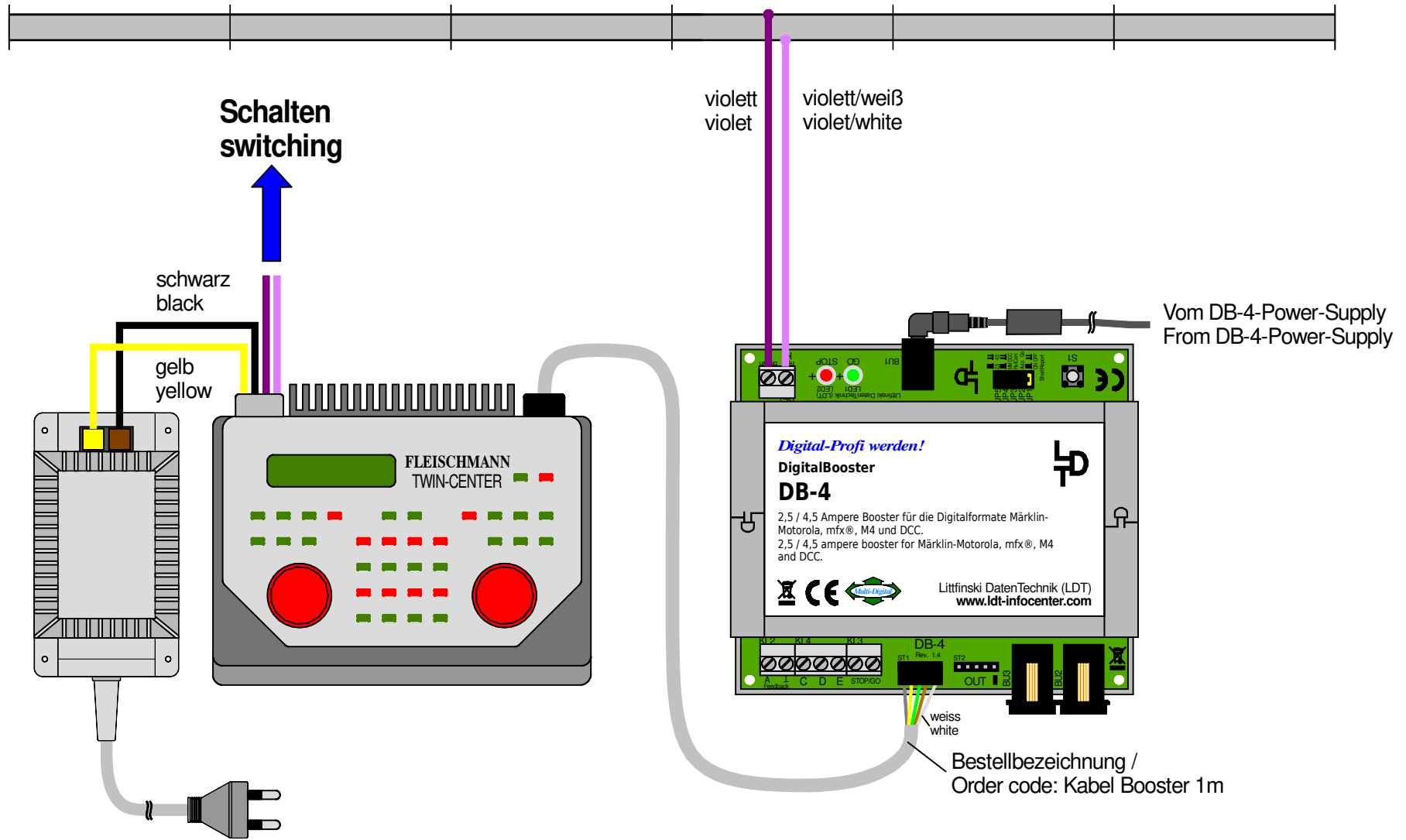

Technische Änderungen und Irrtum vorbehalten.
 Subject to technical changes and errors.
 © 06/2020 by LDT

